

SF/SA 50Hz SERIES

SUBMERSIBLE STAINLESS
STEEL PUMPS



SF *Stainless Steel Sewage / Wastewater Submersible Pump*
SA *Stainless Steel Wastewater / Effluent Submersible Pump*

FEATURES

- Precision casting with the use of an advanced stainless investment casting method, produces the highest quality with a smooth surface finish.
- Standard accessories include : cable with an epoxy resin sealed water-resistant cable base, Auto-cut motor protector, dual mechanical seals and oil seal design.
- Chemically protected Viton O-rings to handle acidic and corrosive fluids.
- Pump hydraulic body made of corrosion resistant SUS316/SCS14 stainless steel material, to handle low pH value chemical media and/or seawater applications.
- Austenitic Stainless Steel(SUS300 series)is used in SF/SA series. SUS316/SCS14 is better than SUS304/SCS13 in water application of light acid-base.
- pH2~10 (As reference at operating temperature range 0 - 40°C)

APPLICATIONS

- Wastewater treatment in food and wine-making industry.
- Wastewater treatment of acid fluid in gold mining, petroleum industry and dyeing industry.
- Chemicals, low pH, corrosive and sea water applications.

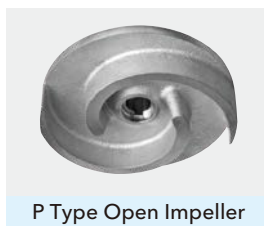
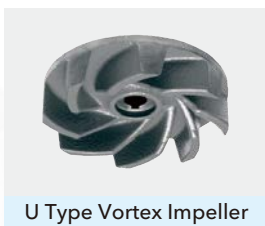

PRODUCT NOMENCLATURE

80	SF	P	2	3.7
Discharge mm	Type	Impeller type	Pole	kW
50	SA	2	8	A
Discharge mm	Type	Pole	kW	Style

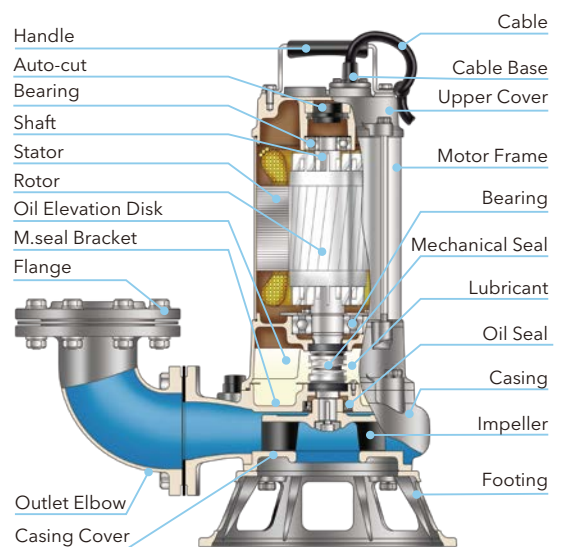

ACCESSORIES :
ELBOW / GRS - GUIDE RAIL SYSTEMS

SF/SA pumps can be installed with 90° Elbow Flange outlet or GRS guide rail system, to have easier / safer installation or removal during replacement and maintenance.





PERFORMANCE CURVES

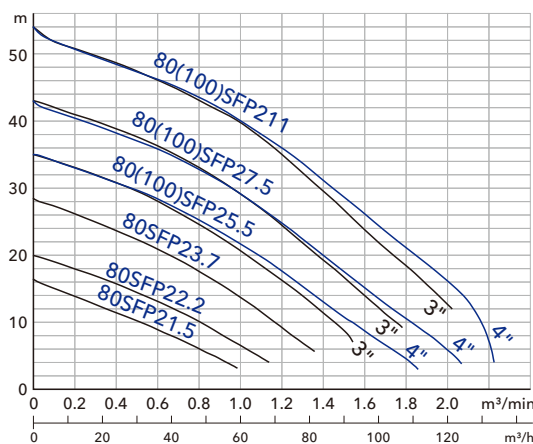
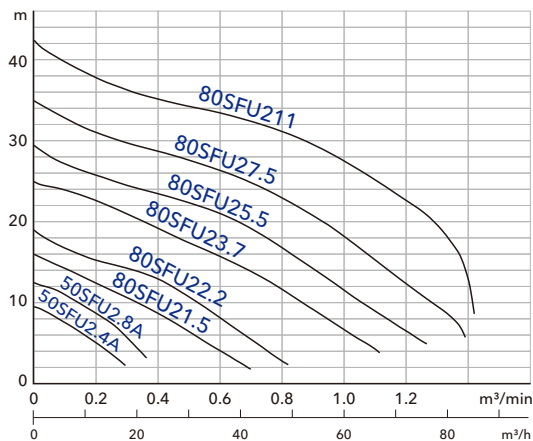

SPECIFICATIONS

Item		Description
Limits of Use	Liquid Temp.	0~40°C (32~104°F)
	Applications	Corrosive • Food • Processing Liquids
Type	Frequency	50Hz
	Motor	2P(3000rpm) • Dry Motor
	Insulation	Class B (0.5~1HP) • Class F (2~5HP) • Class H (7.5~15HP)
	Protection	IP68
	Protector	Thermal (0.5HP 1Ø) • Auto-cut (0.5HP 3Ø~10HP) • MTS & MS(15HP)
	Bearing	Ball type
	M.seal	Double M.seals
Material	Impeller	Vortex • Open
	Upper Cover	SCS14
	Motor Frame	SUS316
	Shaft	SUS316 (0.5~10HP) • SUS630 (15HP)
	M.seal	CA/CE & SiC/SiC
	O-ring	Viton
	Casing	SCS14
	Impeller	SCS14
	Cable	VCT or H07RN-F
	Optional	Pump can be customized to fit specifications

PERFORMANCE SPECS.

※ Note : Weight Without Cable & Elbow Set
Star Method: Y-D = STAR-DELTA.

	Model	Output HP(kW)	Discharge Inch(mm)	Phase Ø	Start Method	Head m	Standard		Solid Passage mm	Weight kg		Dimensions mm				
							m³/min	m³/h		1Ø	3Ø	A	B	C	D	
											1Ø	3Ø				
U Type	50SFU2.4A	0.5(0.4)	2"(50)	1/3	Capacitor DOL	6	0.15	9	35	15	14	237	-	153	432	432
	50SFU2.8A	1(0.75)	2"(50)	1/3	Capacitor DOL	8	0.2	12	35	16	15	237	-	153	432	432
	80SFU21.5	2(1.5)	3"(80)	1/3	Capacitor DOL	8.5	0.4	24	50	30.5	26.5	402	260	202	586	517
	80SFU22.2	3(2.2)	3"(80)	1/3	Capacitor DOL	13	0.4	24	50	34	29	402	260	202	598	517
	80SFU23.7	5(3.7)	3"(80)	3	DOL	17.5	0.5	30	50	-	40	476	286	222	-	561
	80SFU25.5	7.5(5.5)	3"(80)	3	DOL	21	0.6	36	50	-	61	499	309	258	-	657
	80SFU27.5	10(7.5)	3"(80)	3	DOL	26	0.6	36	50	-	67	499	309	258	-	657
	80SFU211	15(11)	3"(80)	3	Y-D/DOL	33	0.6	36	50	-	76	499	309	258	-	697
P Type	80SFP21.5	2(1.5)	3"(80)	1/3	Capacitor DOL	8.5	0.6	36	35	32.5	28.5	417	275	260	590	521
	80SFP22.2	3(2.2)	3"(80)	1/3	Capacitor DOL	12.5	0.6	36	35	36.5	31.5	417	275	260	602	521
	80SFP23.7	5(3.7)	3"(80)	3	DOL	20.5	0.6	36	32	-	43	495	305	290	-	568
	80(100)SFP25.5	7.5(5.5)	3"(80)	3	DOL	28	0.6	36	30	-	67	563	373	345	-	684
			4"(100)			21.5	1.0	60				591				
	80(100)SFP27.5	10(7.5)	3"(80)	3	DOL	35.5	0.6	36	30	-	73	563	373	345	-	684
			4"(100)			29	1.0	60				591				
	80(100)SFP211	15(11)	3"(80)	3	Y-D/DOL	46	0.6	36	30	-	82	563	373	345	-	724
4"(100)			39.5			1.0	60	591								

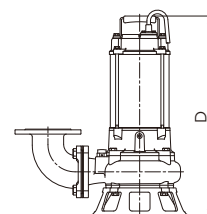
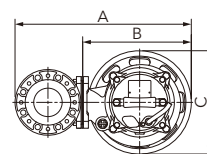



PERFORMANCE CURVES

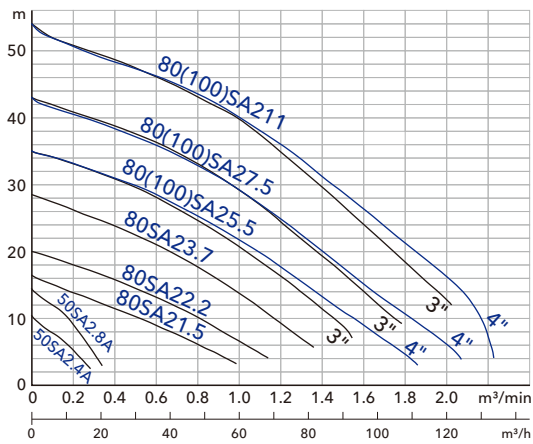

80(100)SA25.5/27.5/211



80SA21.5/22.2/23.7



50SA2.4A/2.8A

PERFORMANCE SPECS.

※ Note : Weight Without Cable & Elbow Set
Star Method : Y-D = STAR-DELTA.

Model	Output HP(kW)	Discharge Inch(mm)	Phase Ø	Start Method	Head m	Standard		Solid Passage mm	Weight kg		Dimensions mm				
						m³/min	m³/h		1Ø	3Ø	A	B	C	1Ø D 3Ø	
50SA2.4A	0.5(0.4)	2"(50)	1	Capacitor	6.5	0.15	9	10	14	14	244	-	172	435	435
				DOL											
50SA2.8A	1(0.75)	2"(50)	1	Capacitor	10	0.17	10.2	10	16	15	244	-	172	435	435
				DOL											
80SA21.5	2(1.5)	3"(80)	1	Capacitor	8.5	0.6	36	20	33.5	29.5	390	248	212	589	520
				DOL											
80SA22.2	3(2.2)	3"(80)	1	Capacitor	12.5	0.6	36	20	37.5	32.5	390	248	212	601	520
				DOL											
80SA23.7	5(3.7)	3"(80)	3	DOL	20.5	0.6	36	20	-	44.5	465	275	239	-	568
80(100)SA25.5	7.5(5.5)	3"(80)	3	DOL	28	0.6	36	20	-	67	528	338	286	-	684
		4"(100)			21.5	1.0	60				556				
80(100)SA27.5	10(7.5)	3"(80)	3	DOL	35.5	0.6	36	20	-	73	528	338	286	-	684
		4"(100)			29	1.0	60				556				
80(100)SA211	15(11)	3"(80)	3	Y-D/DOL	46	0.6	36	20	-	82	528	338	286	-	724
		4"(100)			39.5	1.0	60				556				

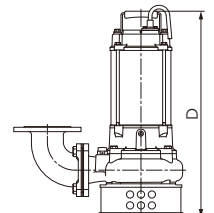
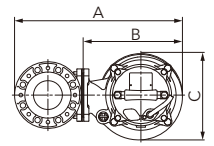

Professionalism · Innovation · Service · Commitment
HCP PUMP MANUFACTURER CO., LTD.
www.hcppump.com



Distributor:

DSAEN5-2207